

Rated voltage: 12 V **Capacity:** 75Ah C₁₀ at 25°C to 1.80V per cell

- * Designed service life of 10 years
- * World-wide compatibility
- * Easy maintenance with low operation cost
- * Easy installing and parameters readings
- * Wide operation temperature range
- * Superior low current discharge performance
- * Better safety performance and reliability
- * Modular and installation design
- * Environmental friendly

Size: 258x166x215mm

Weight: 24kg

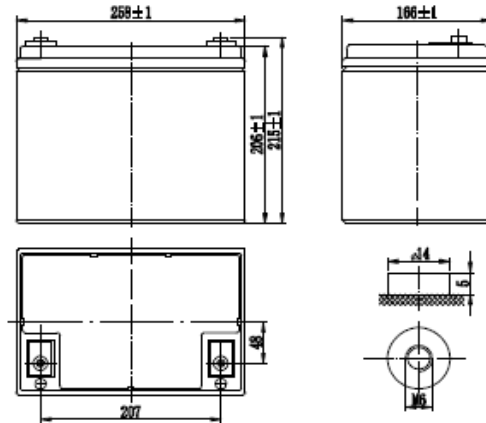

Application:

Telecommunication
 UPS
 Solar and wind power system
 Electric power, nuclear power
 Marine

Company Certificates

ISO 9001:2009
 ISO 14001:2005
 OHSAS 18001:2008



Technical details

Max discharge current:	700A (5sec)	Self-discharge:	less than 9% / 90 days @ 25°C
Internal resistance (charged):	5,7mΩ @ 25°C	Max charge current:	22,5A
Temperature range		Charge voltage at 20°C	Float: 2.26-2.30V Cycle: 2.40-2.45V
Application temperature:	-20°C ~ 60°C	Terminal output:	M6
Storage:	-20°C ~ 60°C	Container	ABS
Charge:	-10°C ~ 50°C		
Temperature compens.factor:	30 mV/°C		

Temperature effect on battery capacity: 105 % @ 40°C; 85 % @ 0°C; 60 % @ -20°C

Discharge current (A/25°C, 68°F):

End Voltage	5min	10min	15min	30min	1h	3h	5h	10h	24h
1,60	240	178	137	81,8	50,2	21,8	14,3	7,67	3,52
1,65	222	169	131	78,3	47,5	21,4	14,1	7,65	3,50
1,70	206	158	122	77,0	46,9	21,0	13,9	7,60	3,48
1,75	195	151	117	73,6	45,3	20,6	13,5	7,55	3,46
1,80	180	139	112	73,1	43,4	19,8	13,3	7,50	3,43

Discharge power (W/25°C, 68°F):

End Voltage	5min	10min	15min	30min	45min	1h	2h	3h	5h
1,60	413	314	246	158	120	95,7	54,1	40,2	26,8
1,65	403	300	241	153	118	93,6	52,8	39,2	26,6
1,70	375	290	237	145	111	89,8	51,6	38,9	26,0
1,75	356	274	223	142	111	86,5	50,3	38,3	26,0
1,80	351	261	212	41	106	84,2	49,6	38,0	25,8

Discharge curves

Temperature and capacity relation

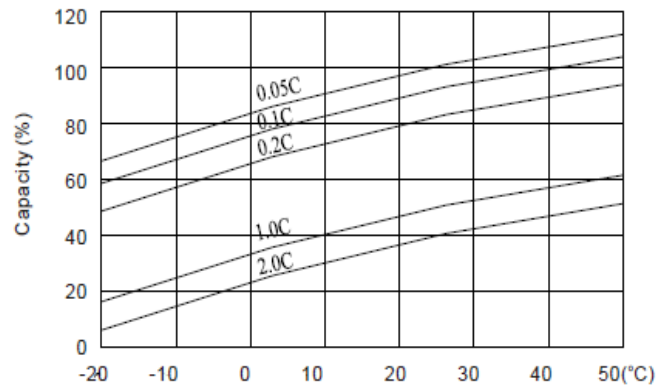
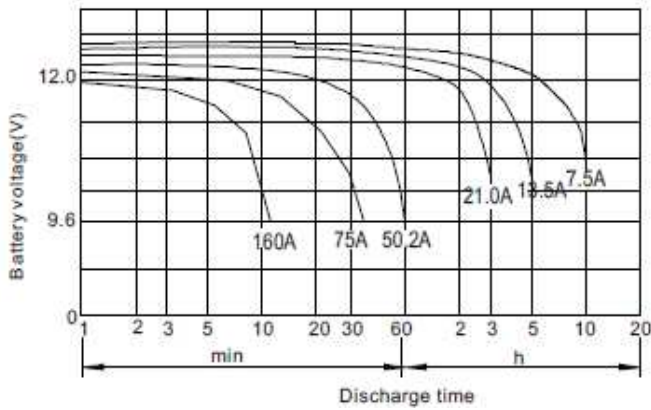

Selfdischarge at different temperature

Constant voltage charge characteristic

