

**Rated voltage:** 12 V    **Capacity:** 120Ah C<sub>10</sub> at 25°C to 1.80V per cell

- \* Designed service life of 10 years
- \* World-wide compatibility
- \* Easy maintenance with low operation cost
- \* Easy installing and parameters readings
- \* Wide operation temperature range
- \* Superior low current discharge performance
- \* Better safety performance and reliability
- \* Modular and installation design
- \* Environmental friendly

**Size:** 410x176x224mm

**Weight:** 38kg

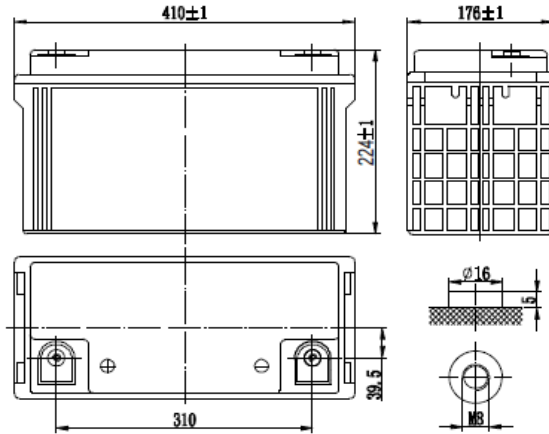

**Application:**

Telecommunication  
 UPS  
 Solar and wind power system  
 Electric power, nuclear power  
 Marine

**Company Certificates**

ISO 9001:2009  
 ISO 14001:2005  
 OHSAS 18001:2008



**Technical details**

|                                       |              |                               |  |
|---------------------------------------|--------------|-------------------------------|--|
| <b>Max discharge current:</b>         | 950A (5sec)  | <b>Self-discharge:</b>        | less than 9% / 90 days @ 25°C          |
| <b>Internal resistance (charged):</b> | 5,3mΩ @ 25°C | <b>Max charge current:</b>    | 36A                                    |
| <b>Temperature range</b>              |              | <b>Charge voltage at 20°C</b> | Float: 2.26-2.30V<br>Cycle: 2.40-2.45V |
| <b>Application temperature:</b>       | -20°C ~ 60°C | <b>Terminal output:</b>       | M8                                     |
| <b>Storage:</b>                       | -20°C ~ 60°C | <b>Container</b>              | ABS                                    |
| <b>Charge:</b>                        | -10°C ~ 50°C |                               |  |
| <b>Temperature compens.factor:</b>    | 30 mV/°C     |                               |  |

**Temperature effect on battery capacity:**    105 % @ 40°C; 85 % @ 0°C; 60 % @ -20°C

**Discharge current (A/25°C, 68°F):**

| End Voltage | 15min | 20min | 30min | 45min | 1h   | 3h   | 5h   | 10h  | 24h  |
|-------------|-------|-------|-------|-------|------|------|------|------|------|
| 1,60        | 196   | 158   | 120   | 95,8  | 71,6 | 32,0 | 21,0 | 12,5 | 5,54 |
| 1,65        | 195   | 156   | 116   | 93,6  | 71,1 | 31,5 | 21,0 | 12,3 | 5,47 |
| 1,70        | 187   | 150   | 112   | 90,9  | 69,7 | 31,0 | 20,7 | 12,2 | 5,39 |
| 1,75        | 179   | 144   | 108   | 87,8  | 67,5 | 30,5 | 20,0 | 12,1 | 5,31 |
| 1,80        | 167   | 137   | 106   | 85,7  | 65,4 | 28,1 | 19,3 | 12,0 | 5,24 |

**Discharge power (W/25°C, 68°F):**

| End Voltage | 15min | 20min | 30min | 45min | 1h  | 3h   | 5h   | 10h  | 24h  |
|-------------|-------|-------|-------|-------|-----|------|------|------|------|
| 1,60        | 370   | 299   | 227   | 172   | 141 | 59,2 | 39,5 | 23,3 | 11,0 |
| 1,65        | 358   | 289   | 220   | 171   | 137 | 56,6 | 38,9 | 23,2 | 10,8 |
| 1,70        | 346   | 280   | 213   | 157   | 131 | 55,0 | 38,3 | 23,0 | 10,6 |
| 1,75        | 334   | 270   | 206   | 154   | 128 | 54,1 | 37,4 | 22,8 | 10,4 |
| 1,80        | 310   | 254   | 199   | 150   | 124 | 53,0 | 37,0 | 22,3 | 10,2 |

**Discharge curves**

**Temperature and capacity relation**

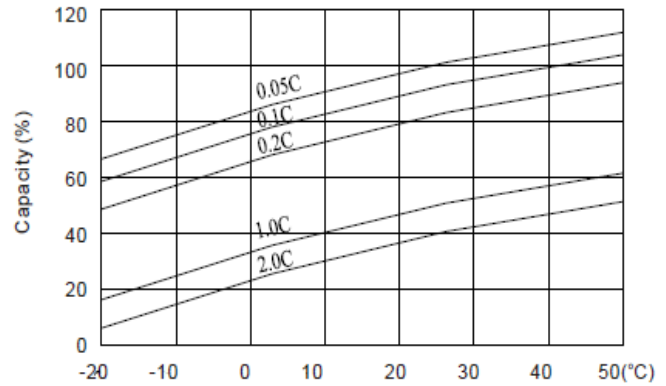
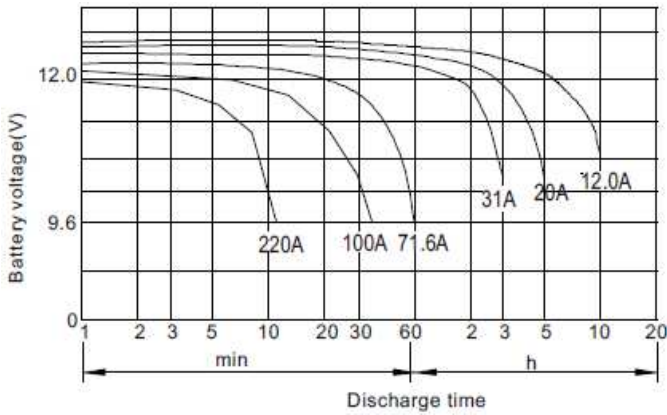

**Selfdischarge at different temperature**

**Constant voltage charge characteristic**

