

**Rated voltage:** 12 V    **Capacity:** 100Ah C<sub>10</sub> at 25°C to 1.80V per cell

- \* Designed service life of 10 years
- \* World-wide compatibility
- \* Easy maintenance with low operation cost
- \* Easy installing and parameters readings
- \* Wide operation temperature range
- \* Superior low current discharge performance
- \* Better safety performance and reliability
- \* Modular and installation design
- \* Environmental friendly

**Size:** 330x171x215(220)mm  
**Weight:** 32kg

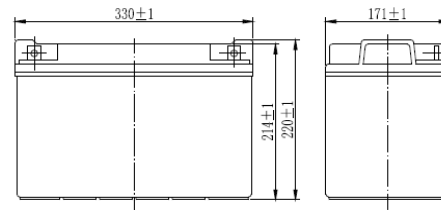

**Application:**

Telecommunication  
 UPS  
 Solar and wind power system  
 Electric power, nuclear power  
 Marine

**Company Certificates**

ISO 9001:2009  
 ISO 14001:2005  
 OHSAS 18001:2008



**Technical details**

<b>Max discharge current:</b>	900A (5sec)	<b>Self-discharge:</b>	less than 9% / 90 days @ 25°C
<b>Internal resistance (charged):</b>	5,7mΩ @ 25°C	<b>Max charge current:</b>	30A
<b>Temperature range</b>		<b>Charge voltage at 20°C</b>	Float: 2.25-2.30V Cycle: 2.40-2.45V
<b>Application temperature:</b>	-20°C ~ 60°C	<b>Terminal output:</b>	M8
<b>Storage:</b>	-20°C ~ 60°C	<b>Container</b>	ABS
<b>Charge:</b>	-10°C ~ 60°C		
<b>Temperature compens.factor:</b>	-20 mV/°C		

**Temperature effect on battery capacity:**    105 % @ 40°C 85 % @ 0°C; 60 % @ -20°C

**Discharge current (A/25°C, 77°F):**

End Voltage	10min	15min	30min	1h	3h	5h	10h	24h
1,60	229,0	185,0	108,0	66,2	27,9	19,0	10,8	4,70
1,65	221,0	178,0	104,0	62,5	27,7	18,3	10,6	4,68
1,70	200,0	164,0	96,0	61,5	27,2	18,0	10,6	4,59
1,75	187,0	153,0	93,0	60,5	26,9	17,5	10,3	4,50
1,80	175,0	143,0	91,0	57,4	25,3	17,2	10,0	4,42

**Discharge power (W/25°C, 77°F):**

End Voltage	10min	15min	30min	1h	3h	5h	10h	24h
1,60	392,0	321,0	199,0	124,0	52,8	35,8	20,3	9,25
1,65	379,0	315,0	188,0	118,0	51,2	35,4	20,1	9,20
1,70	360,0	299,0	183,0	114,0	50,9	35,0	20,0	9,13
1,75	353,0	294,0	177,0	111,0	49,1	34,4	19,6	8,98
1,80	329,0	279,0	171,0	104,0	48,5	34,0	19,1	8,74

**Discharge curves**

**Temperature and capacity relation**

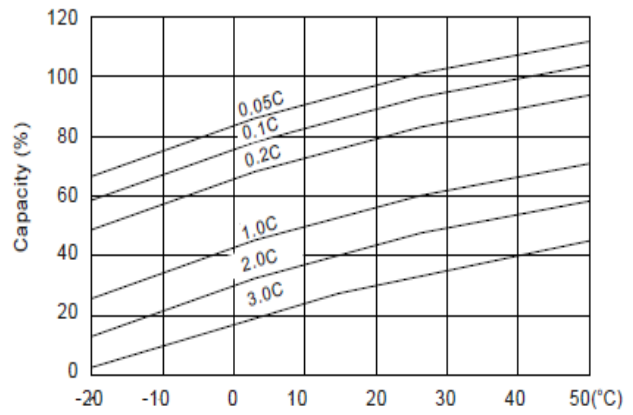
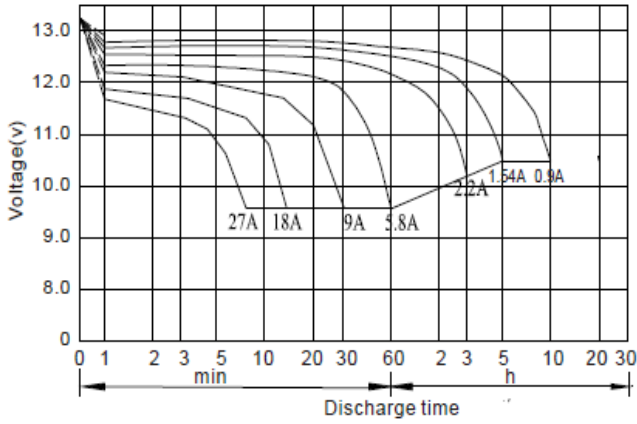

**Selfdischarge at different temperature**

**Constant voltage charge characteristic**

